

First Reading: February 11, 2014
Second Reading: February 18, 2014

2014-007
Alan Haniszewski/
ALC Holdings
District No. 7
Planning Version

ORDINANCE NO. 12808

AN ORDINANCE TO AMEND CHATTANOOGA CITY CODE, PART II, CHAPTER 38, ZONING ORDINANCE, SO AS TO REZONE PROPERTY LOCATED IN THE 2000 BLOCK OF ROSSVILLE AVENUE, MORE PARTICULARLY DESCRIBED HEREIN, FROM M-1 MANUFACTURING ZONE TO C-3 CENTRAL BUSINESS ZONE, SUBJECT TO CERTAIN CONDITIONS.

SECTION 1. BE IT ORDAINED BY THE CITY COUNCIL OF THE CITY OF CHATTANOOGA, TENNESSEE, That Chattanooga City Code, Part II, Chapter 38, Zoning Ordinance, be and the same hereby is amended so as to rezone property located in the 2000 block of Rossville Avenue, more particularly described herein:

Part of Lots 12 and 13 and all of Lot 11, Block 9 of Amended Boyce Addition No. 2, Plat Book 5, Page 10, ROHC, being the property described in Deed Book 10058, Page 449, ROHC. Tax Map No. 145M-U-010.

and as shown on the maps attached hereto and made a part hereof by reference, from M-1 Manufacturing Zone to C-3 Central Business Zone.

SECTION 2. BE IT FURTHER ORDAINED, That this rezoning shall be subject to the following:

1. The permitted use shall be restricted to residential.
2. Review.

The following review shall be required to promote compliance with the Downtown Plan, to help ensure that new development complements the existing urban fabric, and to promote the preservation of historically or architecturally significant structures.

A. For any activity requiring a land disturbing permit or residential building permit for structures with more than two (2) units, and excluding all interior renovations:

(1) The Applicant is required to schedule a meeting with the Community Design Group during the concept development phase of site design.

B. For any activity requiring a residential building permit for new construction:

(1) The Applicant shall provide illustrations, such as specifications, photographs, or other images, to the Community Design Group for review of the work to be completed.

3. Setbacks.

A. For new multi-family buildings three (3) stories in height or greater, and for all new non-residential buildings, a zero building setback is required along the street frontage.

(1) To accommodate outdoor pedestrian activities including a park, plaza, or outdoor dining, a greater setback is permitted if a street edge delineating the public and private space is provided in accordance with Condition 6.A.

B. For new single-family detached, duplex, townhome, and multi-family structures less than three (3) stories in height, building setbacks shall be consistent with the existing setbacks on the same side of the street.

4. Access to sites and buildings.

- A. New curb cuts shall not be permitted on the primary, or highest order street, that a property fronts, except when there is no alley or secondary street to provide access. The permitting and location of curb cuts on primary streets shall be approved by the City Traffic Engineer based on vehicular and pedestrian safety concerns.
 - B. Alleys, where they exist, shall be used as the principal vehicular access.
 - C. In the absence of alleys, the secondary, or lower order street, shall be used as the principal vehicular access.
 - D. Shared drives should be used wherever possible.
 - E. The primary pedestrian entrance to new buildings shall be provided from the primary street.
5. Off-street parking.
- A. New off-street parking shall not be permitted between a building and the primary street frontage.
 - B. For new construction of a primary building, or improvements altering more than 25% of the parcel that is covered in pavement (including gravel, impervious surfaces, and pavers), the following is required:
 - (1) Off-street parking fronting a public street shall be screened from the right-of way with a street edge in accordance with Condition 6.A. Front end in or parallel parking along alleys is exempt from this requirement.
 - (2) Surface parking lots shall be landscaped with a minimum of one (1) Class I shade tree for every five parking spaces. Where conflicts with overhead utility lines exist, Class II shade trees may be used.
 - C. Garages for new residential dwellings shall be located behind the primary building.

D. There are no minimum requirements for the quantity of off-street parking spaces. However, site plans shall indicate the quantity and location of off-street parking provided, along with the following information:

- 1) Proximity to transit stops;
- 2) Provision of bicycle facilities;
- 3) Availability of adjacent on-street parking, proximity to public parking facilities, shared private parking, or leased off-site parking;
- 4) Type of uses and hours of operation;
- 5) Square footage of commercial uses or number of residential units; and
- 6) Fire Department access.

6. Street Frontage.

A. Where a street edge is required, it shall be provided as follows:

1. The street edge shall have a minimum height of three (3) feet and a maximum height of four (4) feet above grade and shall consist of:
 - a) Brick, stucco, or stone walls (concrete block is permitted if faced with said materials); or
 - b) A decorative metal fence with landscaping a minimum of 3 feet in height at maturity, providing a year-round near opaque screen; or
 - c) An evergreen hedge, with a minimum height at maturity of three (3) feet.
 - d) Highway-style guardrails or security fencing (e.g. chain link) shall not be permitted.
2. All dumpsters and mechanical equipment shall be placed to the rear of the property and shall be screened from all public rights-of-way.

SECTION 3. BE IT FURTHER ORDAINED, That this Ordinance shall take effect two
(2) weeks from and after its passage.

Passed on second and final reading: February 18, 2014



CHAIRPERSON

APPROVED: DISAPPROVED:



MAYOR

/mms

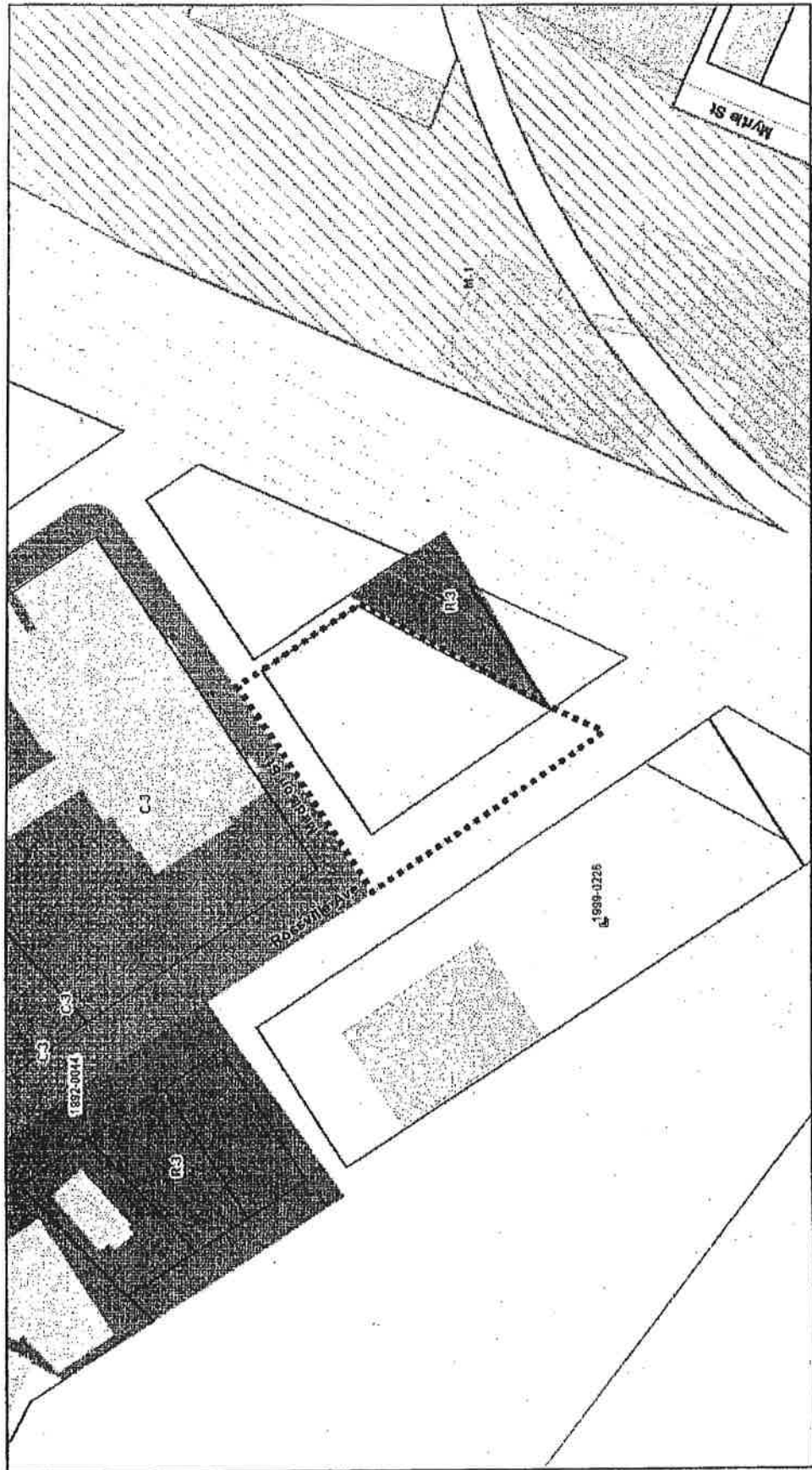

2014-007 Rezoning from M-1 to C-3



101 ft



Hamilton County Regional Planning Agency

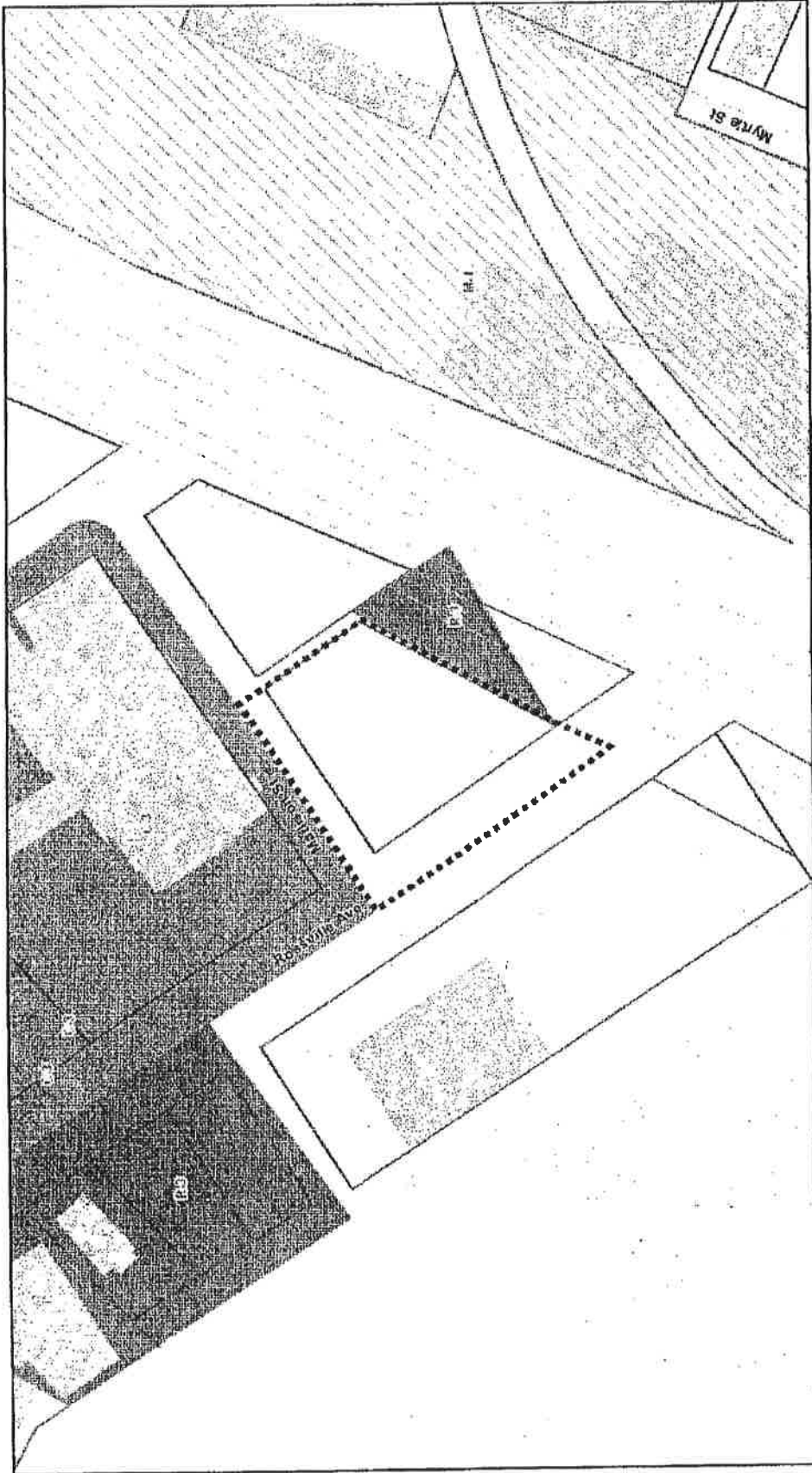

2014-007 Rezoning from M-1 to C-3

PLANNING COMMISSION RECOMMENDATION FOR CASE NO. 2014-007. Approve, subject to the conditions listed in the Planning Commission Resolution.



100 ft

Chattanooga, Hamilton County
RPA
 Regional Planning Agency

Chattanooga Hamilton County Regional Planning Agency

Site Plan
 Being All Of Lot 11 And Parts Of Lots 12 And 13 Boyce's
 Amended Addition No. 2
 Recorded in Plat Book 6, Page 99 R.O.H.C.
 Chattanooga, Hamilton County, Tennessee
 Scale: 1" = 40' November 28, 2013



For:
 ALC Holdings, LLC
 1925 Rossville Ave
 Chattanooga, TN 37408
 423-505-5187

I certify that I have surveyed the property shown
 herein, that the survey is correct to the best of
 my knowledge and that the total of
 the area of the enclosed survey is greater than
 1:110,000 (Category 1)

Alan Haniszewski
 Tennessee PLS #2398
 3073 Baggett Trail
 Signal Mountain, TN 37377
 423-384-6032
 a_haniszewski@yahoo.com

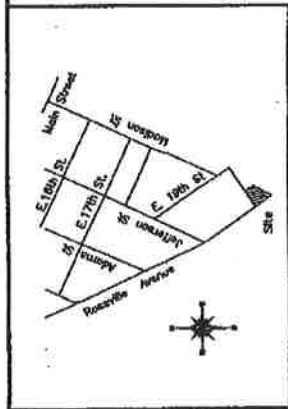

- Notes:**
- 1.) All lots to have rear or side entry garages and off street parking pod.
 - 2.) Project area: 15,833 sq.ft., 0.3± ac.
 - 3.) Tax Parcel #145M-U-010.
 - 4.) No landscape ordinances.
 - 5.) Currently Zoned M-1.

Zoned C-3

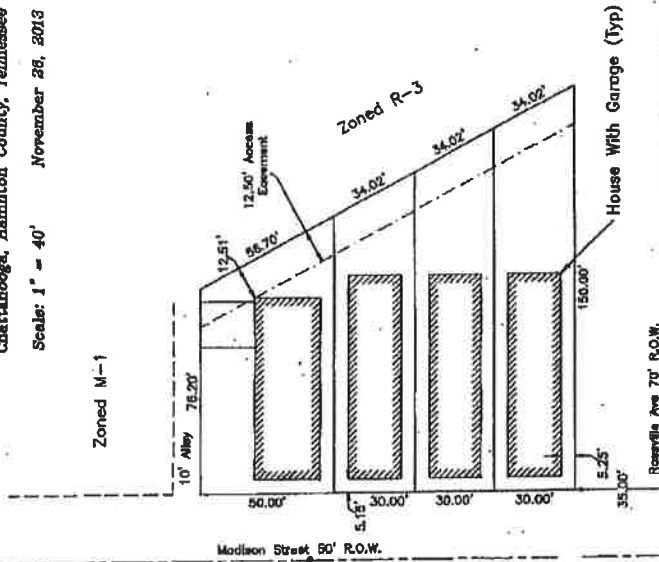

File Name: Boyce's 11-13 Site
 Drawing No. 13-196-1

Zoned M-1